

1/2-type Zoom Lenses

(For 1/3-type and 1/2-type CCD Cameras)

Unit = mm (inches)

WV-LZ81/6A 6x Zoom Lens

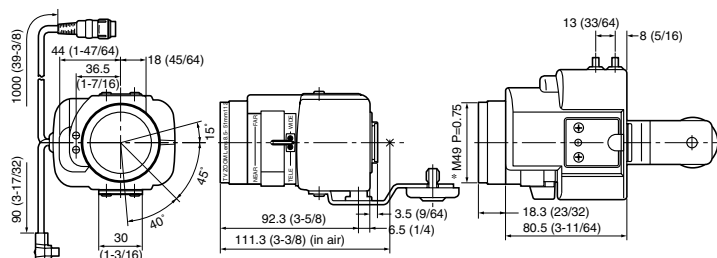

Focal Length	8.5 - 51 mm (6x)	Mount	Special C-Mount (CS-Mount, 1-32UN)	Focus Control	Far	24 mA at -6V DC	
Aperture Ratio	F1.2 (Wide) to F64, close F1.3 (Tele) to F64, close	Weight	420 g (0.93 lbs.)	Focus Control	Near	24 mA at +6V DC	
Image Size	6.4(H) x 4.8(V) mm (equivalent to 1/2")	Dimensions (W x H x D)	85 x 66 x 114 mm (3-3/8" x 2-7/16" x 3-7/8")	Zoom Control	Wide	24 mA at -6V DC	
Angular Field of View 1/2"	H 7.2° (Tele) 41.9° (Wide) V 5.5° (Tele) 31.3° (Wide)	Zoom and Focus Control	Control Voltage ±6 to ±12V DC (Accept, Wide Voltage)	Pin Configuration	<ol style="list-style-type: none"> Common Not Used Focus Zoom 		
Angular Field of View 1/3"	H 5.5° (Tele) 31.4° (Wide) V 4.1° (Tele) 23.5° (Wide)						Polarity Zoom: (+) Tele (-) Wide Focus: (+) Near (-) Far
Iris Type	Automatic						Operating Speed Zoom: Approx. 9 sec. at ±6V DC Approx. 6 sec. at ±8V DC Approx. 4 sec. at ±12V DC Focus: Approx. 8 sec. at ±6V DC Approx. 4 sec. at ±8V DC Approx. 2 sec. at ±12V DC
Minimum Object Distance	1 m (3.3 ft.)						
Optical Filter Size	M49 mm, P = 0.75 mm						

*Lens has mechanical focus adjustment ring.

WV-LZ81/10 10x Zoom Lens

Unit = mm (inches)

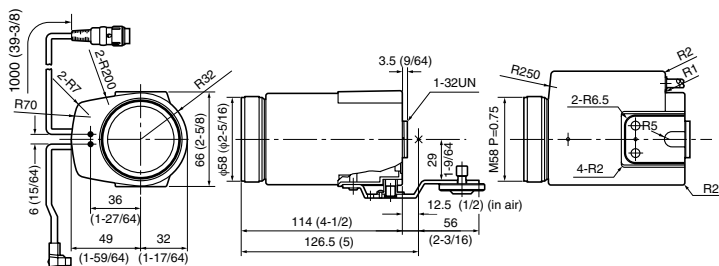

Focal Length	8 - 80 mm (10x)	Mount	Special C-Mount (CS-Mount, 1-32UN)	Focus Control	Far	67 mA at -8V DC	
Aperture Ratio	F1.4 (Wide) to F64, close F1.7 (Tele) to F64, close	Weight	450 g (0.99 lbs.)	Focus Control	Near	35 mA at +8V DC	
Image Size	6.4(H) x 4.8(V) mm (equivalent to 1/2")	Dimensions (W x H x D)	81 x 66 x 114 mm (3-3/8" x 2-5/8" x 4-1/2")	Zoom Control	Wide	28 mA at -8V DC	
Angular Field of View 1/2"	H 4.6° (Tele) 44.6° (Wide) V 3.5° (Tele) 33.5° (Wide)	Zoom and Focus Control	Control Voltage ±6 to ±12V DC (Accept, Wide Voltage)	Pin Configuration	<ol style="list-style-type: none"> Common Not Used Focus Zoom 		
Angular Field of View 1/3"	H 3.5° (Tele) 33.5° (Wide) V 2.6° (Tele) 25.2° (Wide)						Polarity Zoom: (+) Tele (-) Wide Focus: (+) Near (-) Far
Iris Type	Automatic						Operating Speed Zoom: Approx. 9 sec. at ±6V DC Approx. 6 sec. at ±8V DC Approx. 4 sec. at ±12V DC Focus: Approx. 12 sec. at ±6V DC Approx. 7 sec. at ±8V DC Approx. 3 sec. at ±12V DC
Minimum Object Distance	1.1 m (3.6 ft.)						
Optical Filter Size	M55 mm, P = 0.75 mm						

*Lens has mechanical focus adjustment ring.